

SPS-2000 Replacement Parts – New Style Display

(Serial Numbers 1110xxxxxx or Later)

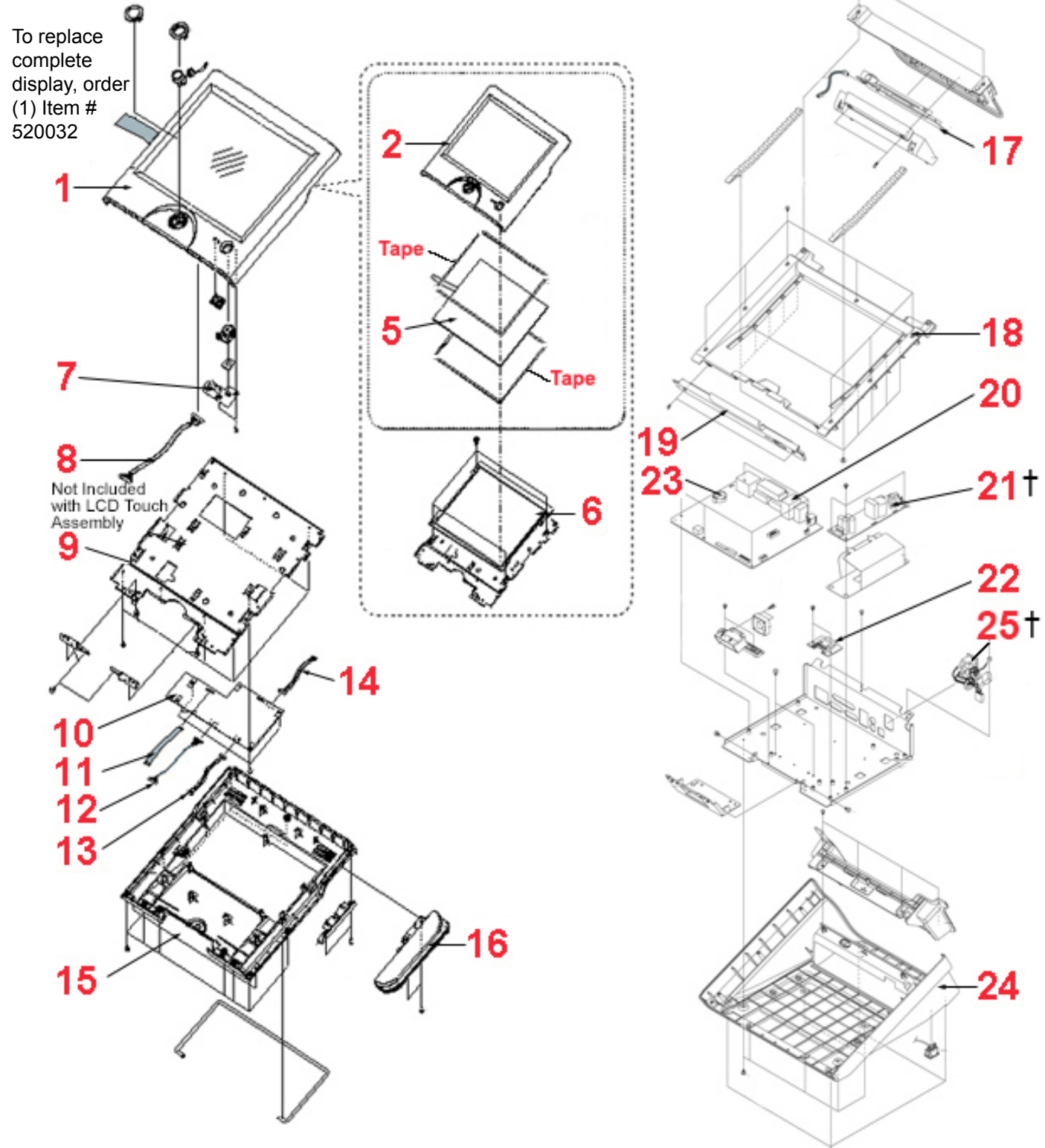

Ref. No.	CRS Item No.	Description
01 **	520032	LCD Touch Assy SPS-2000 N/S
02 **	102294	Case Front Dsply SPS-2000 N/S
Tape*	520020	Tape White Short - SPS-2000
Tape *	520019	Tape White Long - SPS-2000
05 *	520006	Touch Panel SPS-2000
06 **	520030	LCD TFT SPS-2000 N/S Auo
07 *	520014	Board LED Board - SPS-2000
08 **	205293	Harness LVDS SPS-2000 N/S Auo
09 **	520052	Bracket LCD SPS-2000 N/S
10 **	520031	Board Micom SPS-2000 N/S
11 **	205294	Harness Backlit SPS-2000 N/S
12 *	205226	Harness Micom SPS-2000
13 *	205227	Harness LED SPS-2000

Ref. No.	CRS Item No.	Description
14 *	205225	Harness MCR (Set) SPS-2000
15 **	102293	Cover, Rear Dsply SPS-2000 N/S
16 *	520009	MCR Assy - SPS-2000
17 *	520013	Board Rear VFD-Board SPS-2000
18 *	102196	Case Upper - SPS-2000
19 *	102198	Cover, Front SPS-2000
20 *	520023	Main Board V. 2.4 SPS-2000
21 *	520008	Power Supply SPS-2000 N/S
22 *	520012	Board SD Card PCB SPS-2000
23 *	203085	Battery MI2032 SPS-2000 3.0V
24 *	102199	Case, Lower D/Gray SPS-2000
25 *	101420	Cable P/S To MB SPS-2000 O/S

(01) To Replace Complete Display, Order Item # 520032

(08) (10) (11) are No Longer Included When Purchasing the LCD Touch Assembly (Item # 520032)
Please Order Separately

* Parts used by both new and old display models.
 ** Parts used only for new display models.
 † If you install a new-style power supply, you must also install a new-style AC Inlet Harness