

SPS-2000 Replacement Parts – Old Style Display

1 Assembly
Not Available
To replace
complete
display, order
(5) Item #
520006 and
(6) Item #
520007

For SPS-2000s with serial numbers up to 1109xxxxxx

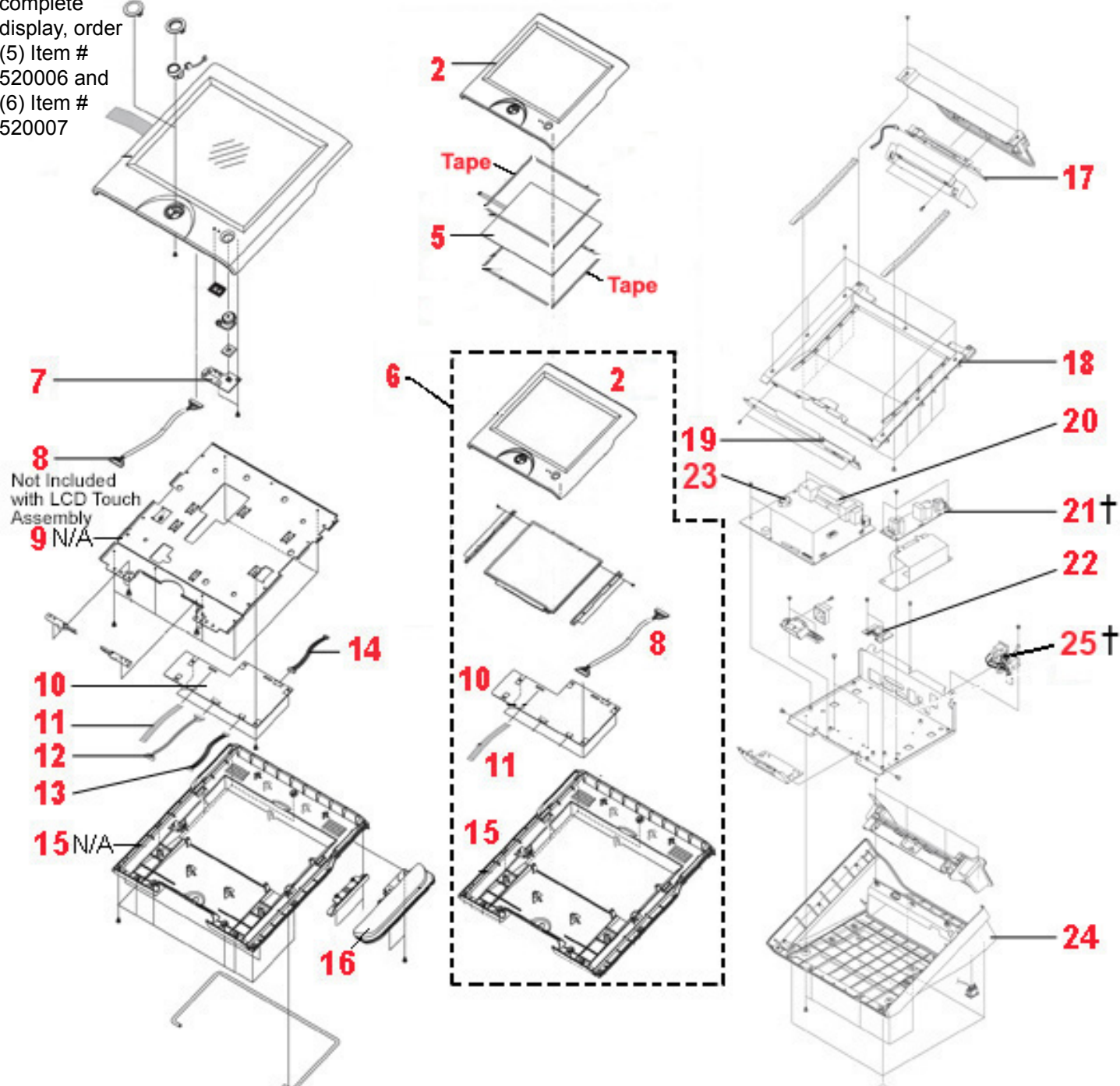

* Parts used by both new and old display models.

** Parts used only for old display models.

† If you install a new-style power supply, you must also install a new-style AC Inlet Harness

Ref. No.	CRS Item No.	Description
06 **	520007	LCD TFT SPS-2000
02 **	102279	Case, Front Display SPS-2000
08 **	205223	Harness LCDS SPS-2000 O/S
10 **	520011	Board Micom SPS-2000
11 **	205224	Harness Inverter SPS-2000
15	N/A	Display Case Rear
Tape*	520020	Tape White Short - SPS-2000
Tape*	520019	Tape White Long - SPS-2000
05 *	520006	Touch Panel SPS-2000
07 *	520014	Board LED Board - SPS-2000
12 *	205226	Harness Micom SPS-2000
13 *	205227	Harness LED SPS-2000

Ref. No.	CRS Item No.	Description
14 *	205225	Harness MCR (Set) SPS-2000
16 *	520009	MCR Assy - SPS-2000
17 *	520013	Board Rear VFD-Board SPS-2000
18 *	102196	Case Upper - SPS-2000
19 *	102198	Cover, Front SPS-2000
20 *	520023	Main Board V. 2.4 SPS-2000
21 *	520008	Power Supply SPS-2000 N/S
22 *	520012	Board SD Card PCB SPS-2000
23 *	203085	Battery MI2032 SPS-2000 3.0V
24 *	102199	Case, Lower D/Gray SPS-2000
25 *	101420	Cable P/S To MB SPS-2000 O/S

(01) Assembly Not Available. To Replace Complete Display, order (05) Item # 520006 and (06) Item # 520007

(06) Includes (02), (08), (10), (11), (15)